

## Angular Contact Ball Bearings

### Brass cage angular contact ball bearing-7317 BECBM

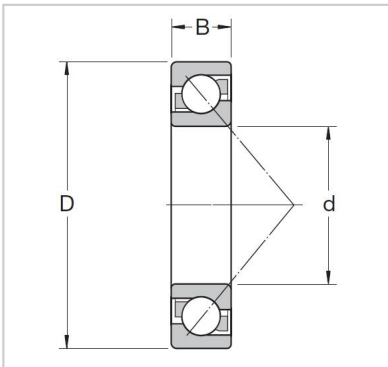

#### Abutment and fillet dimensions

Db max.	<b>7317 BECBM</b>
Da max.	-
da min.	85
rb max.	180
ra max.	41

#### Dimensions

a	156
r3,4 min.	132
r1,2 min	4.9
D1	4 800
d2	4 800
d1	4.45

#### Mass

KG	122
----	-----

#### Speed ratings r/min

Limiting speed	103
Reference speed	145

#### Fatigue load limit

Pu kN	<b>3</b>
-------	----------

#### Basic load ratings KN

dynamic C kN	1.1
static Co kN	76

#### Basic design bearing

B mm	99
D mm	166
d mm	173

#### Basic design bearing

	2.5
--	-----

#### Designations

Universally matchable bearing	<b>1</b>
-------------------------------	----------